

Accessories Modular range

Contact blocks for rear mounting

Description	Catalog No.	Ref. Code	List Price
Contact blocks			
1NO	MCB-10B	1SFA 611 610 R2001	\$ 8.00
1NC	MCB-01B	1SFA 611 610 R2010	

Double contact block

2NO	MCB-20B	1SFA 611 610 R2002	16.00
2NC	MCB-02B	1SFA 611 610 R2020	
1NO+1NC	MCB-11B	1SFA 611 610 R2011	

Contact blocks with gold plated contacts

1NO	MCB-10BG	1SFA 611 610 R2101	16.00
1NC	MCB-01BG	1SFA 611 610 R2110	

Lamp blocks

For max. 2 W, 230 V AC and DC filament bulb or LED

115 V AC supply voltage.

For 60 V filament bulb max. 1.2 W

230 V AC supply voltage.

For 130 V filament bulb max. 2 W

	MLB-1B	1SFA 611 620 R2001	17.50
	MLB-2B	1SFA 611 620 R2002	21.50
	MLB-3B	1SFA 611 620 R2003	21.50

Protective sleeve

Description	Catalog No.	Ref. Code	List Price
To make a rear mounted lamp block screen protected. IP20	53960543-1	5396 0543-1	\$ 2.00

Earthing terminal

Description	Catalog No.	Ref. Code	List Price
For plastic enclosure.	MA5-3005	1SFA 611 925 R3005	\$ 2.00

Shrouds

Color	Catalog No.	Reference Code
Yellow	MA1-8053	1SFA611920R8053
Gray	MA1-8128	1SFA611920R8128

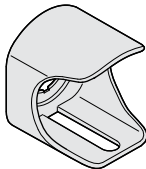
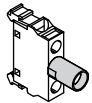
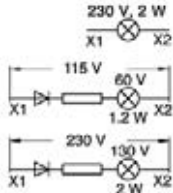
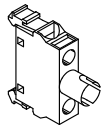
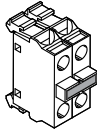
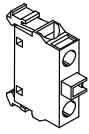

Yellow shroud

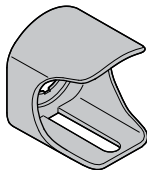

Gray shroud