

2-Position Red Push-Pull and Push-Pull/Twist Release Devices, Non-Illuminated

Note: A jumbo or large legend plate is recommended, if space allows.



2-Position Push-Pull
 Cat. No. 800T-FX6D4



2-Position Metal Push-Pull
 Cat. No. 800T-FXLE6D4S



2-Position Push-Pull / Twist
 Cat. No. 800T-FXT6D4



2-Position Push-Pull / Twist
 Cat. No. 800H-FRXT6D4

Contact Type	Operator Position		Type 4/13		Type 4/4X/13	
			Push-Pull — 40 mm	Push-Pull — 63 mm Metal	Push-Pull/Twist Release	Push-Pull/Twist Release
	Out	In	Cat. No.	Cat. No.	Cat. No.	Cat. No.
N.C.L.B.*	X	O	800T-FX6D4	800T-FXLE6D4	800T-FXT6D4	800H-FRXT6D4
N.O. - N.C.L.B.*	O X	X O	800T-FX6A1	800T-FXLE6A1	800T-FXT6A1	800H-FRXT6A1
N.C.L.B. - N.C.L.B.*	X X	O O	800T-FX6A5	800T-FXLE6A5	800T-FXT6A5	800H-FRXT6A5
S.M.C.B.*	X	O	800TC-FX6D4S	800TC-FXLE6D4S	800TC-FXT6D4S	800HC-FRXT6D4S
N.O. - S.M.C.B.*	O X	X O	800TC-FX6A1S	800TC-FXLE6A1S	800TC-FXT6A1S	800HC-FRXT6A1S
S.M.C.B. - S.M.C.B.*	X X	O O	800TC-FX6A5S	800TC-FXLE6A5S	800TC-FXT6A5S	800HC-FRXT6A5S

Note: X = Closed/O = Open

Note: These caps are only available in plastic.

Note: Emergency stop push buttons are compliant with EN ISO 13850 and EN/IEC 60947-5-5 Standards when using N.C.L.B. contact blocks.

* The Self Monitoring Contact Block (S.M.C.B.) is composed of a N.C.L.B. contact wired in series with a N.O. monitoring contact. The N.O. monitoring contact automatically closes when the S.M.C.B. is properly installed onto the E-stop operator. If the S.M.C.B. is separated from the E-stop operator, the N.O. monitoring contact will automatically open.

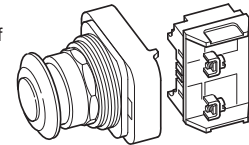

800 T - FX 1 A1
 a b c d e

Protection Rating	
Code	Description
T	Metal, Type 4/13
H	Plastic, Type 4/4X/13

Finger-Safe Guards	
Code	Description
Blank	No guards
C	Guards on terminals

Head Type†		
800T Type 4/13	Description	800H Type 4/4X/13
Code		Code
FX	Mushroom head (push-pull)	—
FXC	90 mm anodized aluminum head (push-pull)	—
FXJ	Jumbo mushroom head (push-pull)	—
FXJE	Jumbo mushroom head (push-pull) with "E-Stop"	—
FXL	63 mm anodized aluminum head (push-pull)	—
FXLE	63 mm anodized aluminum head (push-pull) with "E-Stop"	—
FXT	Push-pull/twist-to-release	FRXT
FXJT	Jumbo head push-pull with twist-to-release	FRXJT

Color Cap	
Code	Color
Blank	No cap§
1	Green
2	Black
3	Orange
4	Grey
5	White
6	Red
7	Blue
9	Yellow

Contact Block(s)			
Code	Operator Position		Description
Blank	—	—	No contacts on operator
Standard			
D1	O	X	1 N.O.
D2	X	O	1 N.C.
D4	X	O	1 N.C.L.B.
A	O	X	1 N.O. - 1 N.C.
A1	O	X	1 N.O. - 1 N.C.L.B.
A5	X	O	2 N.C.L.B.

Contact Block(s)			
Code	Operator Position		Description
Blank	—	—	No contacts
PenTUFF (Low Voltage)			
D1V	O	X	1 N.O.
D2V	X	O	1 N.C.
D4V	X	O	1 N.C.L.B.
AV	O	X	1 N.O. - 1 N.C.
X	X	O	
Class 1, Div. 2/Zone 2			
Logic Reed			
D1R	O	X	1 N.O.
D2R	X	O	1 N.C.
AR	O	X	1 N.O. - 1 N.C.
X	X	O	
Sealed Switch			
D1P	O	X	1 N.O.
D2P	X	O	1 N.C.
AP	O	X	1 N.O.
X	X	O	1 N.C.
Stackable Sealed Switch			
D1Y	O	X	1 N.O.
D2Y	X	O	1 N.C.
AY	O	X	1 N.O. - 1 N.C.
X	X	O	

Note: X = Closed/O = Open

* Normally closed late break contact. When button is pushed from the OUT to IN position, the mechanical detent action of the operator occurs before electrical contacts change state. When the button is pulled from the IN in the OUT position, the electrical contacts change state before the mechanical detent occurs.

† Devices with N.C.L.B. contacts meet EN ISO 13850 and IEC 60947-5-5 standards for emergency stop applications.

§ Not valid with head Type J or JT.

Specifications*

Electrical Ratings		
Contact ratings	Refer to the contact ratings tables on page 10-4.	
Dielectric strength	2200V for one minute, 1300V for one minute (Logic Reed)	
Electrical design life cycles	1 000 000 at max. rated load, 200 000 at max. rated load (Logic Reed)	
Mechanical Ratings		
Vibration	10...2000 Hz, 1.52 mm displacement (peak-to-peak) max./ 10 G max. (except Logic Reed)	
Shock	1/2 cycle sine wave for 11 ms ≥ 25 G (contact fragility) and no damage at 100 G	
Degree of protection	Type 1/4/12/13 (800T); Type 1/4/4X/12/13 (800H); EN/IEC 60529 IP66/65	
Mechanical design life cycles		
Push buttons	(Momentary, non-illuminated)	10 000 000 min.
	(Momentary, illuminated)	250 000 min.
	(Push-pull/twist-to-release)	250 000 min.
Selector switches	(Non-illuminated)	1 000 000 min.
	(Illuminated, key-operated)	200 000 min.
Potentiometers	25 000 min.	
All other devices	200 000 min.	
Contact operation	Shallow, mini, and low-voltage contact blocks: Slow, double make and break Logic Reed and sealed switch contact blocks: Single break magnetic	
Wire gauge/Terminal screw torque	#18...14 AWG (#18...10 Max Duty) / 6...8 lb•in	
Typical operating forces		
Operators without contact blocks	Flush, extended button, standard mushroom, jumbo plastic mushroom: 2 lbs max. Jumbo and extended aluminum mushroom head: 3.95 lbs max. Maintained selector switch: 3.6 in•lb max.	
Spring return selector switches	3.6 in•lb to stop, 0.2 in•lb to return	
Illuminated push buttons and push-to-test pilot lights	5 lb max.	
2-position push-pull	8.0 lb max. push or pull	
3-position push-pull	8 lb max. push to in position or pull to center position (15 lb max. pull to out position)	
Twist-to-release or push-pull	9 lbs max. push or pull 30 in•oz max. twist, 6 in•oz minimum return	
Potentiometer	Rotational torque 3...12 in•oz; stopping torque 12 in•lb (minimum)	
Contact blocks	Standard	1 lb
	Logic Reed	1 lb max.
	Sealed switch	3 lb max. at 0.205 in. plunger travel
	Stackable sealed switch	1 lb max.
	MaxDuty	1.4 lb max.
	PenTUFF	1.4 lb max.
	Self Monitoring	1.6 lb
Environment		
Temperature range	Operating	-40...+131 °F (-40...+55 °C)
	Storage	-40...+185 °F (-40...+85 °C)
Note: Operating temperatures below freezing are based on the absence of moisture and liquids. Consult your local Rockwell Automation sales office or Allen-Bradley distributor for use in lower temperature applications.		
Humidity	50...95% RH from 77...140 °F (25...60 °C) per Procedure IV of MIL-STD-810C, Method 507.1 cycling test	

* Performance Data — See Important- 3.

30.5 mm Push Buttons

Approximate Dimensions

Dimensions in inches (millimeters). Dimensions are not intended to be used for manufacturing purposes.

Push Buttons and Switches (Bul. 800T Only)

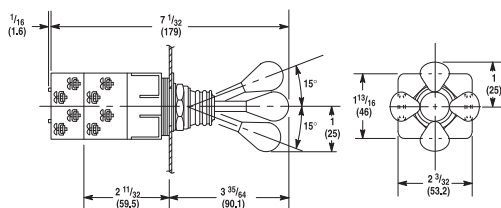

2-3-4 Way Switch

Shipping Wt. with 2 Contact Blocks 6 oz (0.17 kg)
Shipping Wt. with 4 Contact Blocks 8-1/2 oz (0.24 kg)

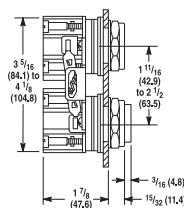

Mechanically Interlocked
Maintained Contact Push Button
Shipping Wt. 1 lb (0.45 kg)

Push Buttons and Pilot Lights

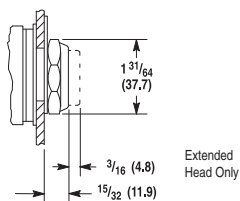

Flush and Extended
Head Push Button

Shipping Wt. 5-1/2 oz (0.15 kg)

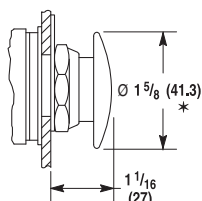

Mushroom Head Push Button
Shipping Wt. 7-1/2 oz (0.21 kg)

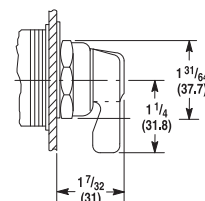

Non-Illuminated Knob Lever and
Standard Knob Selector Switch
Shipping Wt. 6 oz (0.17 kg)

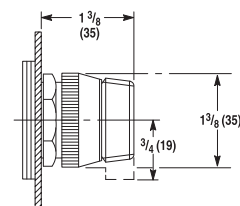

Illuminated Knob Lever and
Standard Knob Selector Switch
Shipping Wt. 6 oz (0.17 kg)

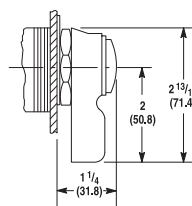

Wing Lever Selector Switch
Shipping Wt. 8 oz (0.22 kg)

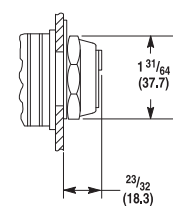

Coin Slot Selector Switch
Shipping Wt. 6 oz (0.17 kg)

* Except jumbo which is 2-1/4 (57.2).

Operator Extension in Front of Panel (Bul. 800T Only)

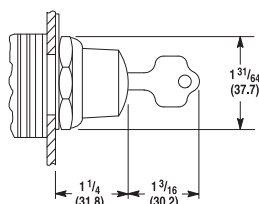

Key Operated Selector Switch
Shipping Wt. 12 oz (0.34 kg)

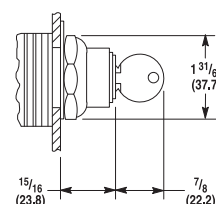

Push Button with Cylinder Lock
Shipping Wt. 12 oz (0.34 kg)

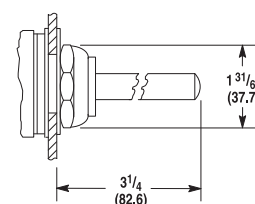

Wobble Stick
Shipping Wt. 9 oz (0.25 kg)

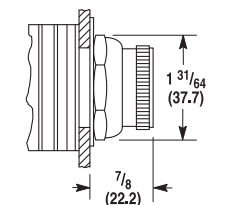

Selector Push Button
Shipping Wt. 6 oz (0.17 kg)

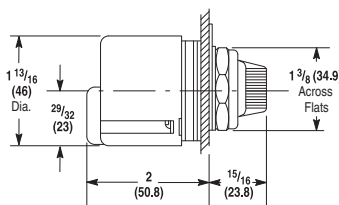

Type J Potentiometer Unit
Shipping Wt. 4 oz (0.11 kg)

