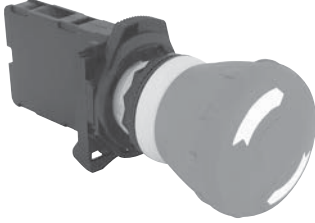

22.5 mm Push Buttons

Quick Selection

Complete Devices, Continued*

Non-Illuminated Emergency Stop Operators, Ø 40 mm, Red (Screw Terminal Connections)

	Description	Type of Contact*		Construction	Pkg. Quantity	Cat. No.
		N.O.	N.C.			
	Twist-to-Release	—	1	Plastic operator/plastic latch	1	800FP-MT44PX01S
		—	1	Metal operator/metal latch		800FM-MT44MX01S
		1	1	Plastic operator/plastic latch		800FP-MT44PX11S
		1	1	Metal operator/metal latch		800FM-MT44MX11S

Cat. No. 800FP-MT44PX01S

* Self-monitoring contact block included when N.C. is specified.

Pilot Lights with Integrated LED Modules (Screw Terminal Connections)

	Voltage	Style	Construction	Pkg. Quantity	Cat. No.
	24V AC/DC	Green	Plastic operator/plastic latch	1	800FP-P3PN3G
		Red			800FP-P4PN3R
		Yellow			800FP-P5PN3Y
		Blue			800FP-P6PN3B
		White			800FP-P7PN3W
	120V AC	Green			800FP-P3PN5G
		Red			800FP-P4PN5R
		Yellow			800FP-P5PN5Y
		Blue			800FP-P6PN5B
		White			800FP-P7PN5W
	240V AC	Green			800FP-P3PN7G
		Red			800FP-P4PN7R
		Yellow			800FP-P5PN7Y
		Blue			800FP-P6PN7B
		White			800FP-P7PN7W

Cat. No. 800FP-P7PN3W

* For complete devices not listed and configuration assistance, see RAISE product selection software (<http://www.ab.com/raise>).

Overview, Continued

3-Across x 2-Deep Back-of-Panel (6 Circuits Max.)

- Rugged snap-fit design for plastic or metal latch
- Stackable contact blocks
- Rotating collar for easy one-hand latch removal
- Color-coded contact block plungers for contact identification



Plastic Latch with Contact Block



Metal Latch with Contact Block

Assembly Overview

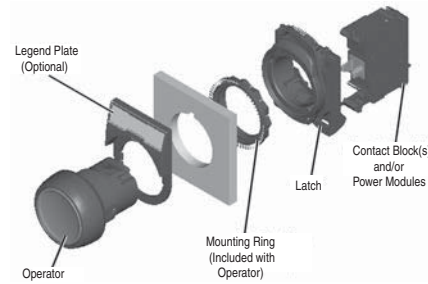

Specifications*

Front-of-Panel (Operators)

Mechanical Ratings		
Description	Plastic (Bulletin 800FP)	Metal (Bulletin 800FM)
Vibration (assembled to panel)	Tested at 10...2000 Hz, 1.52 mm displacement (peak-to-peak) max./10 G max. for 3 hr duration, no damage	
Shock	Tested at 1/2 cycle sine wave for 11 ms; no damage at 100 G	
Degree of protection*	IP65/66 (Type 3/3R/4/4X/12/13)	IP65/66 (Type 3/3R/4/12/13)
Mechanical durability per EN 60947-5-1 (Annex C)	10 000 000 Cycles	Momentary push buttons, momentary mushroom
	1 000 000 Cycles	Multi-function, selector switch, key selector switch, selector jog, SensEject™ key selector switch
	500 000 Cycles	Non-illuminated push-pull E-stop‡
	300 000 Cycles	Twist-to-release E-stop, illuminated push-pull E-stop‡, alternate action push buttons
	100 000 Cycles	Potentiometer, toggle switch
Operating forces (typical with one contact block)	Flush/extended = 5 N, E-stop = 36 N Mushroom = 9 N	
Operating torque (typical application with one contact block)	Selector switch = 0.25 N•m (2.2 lb•in)	
Mounting torque	Plastic	1.7 N•m (15 lb•in)
	Metal	4.4 N•m (40 lb•in)
Environmental		
Temperature range (operating)	-25...+70 °C (-13...+158 °F)§	
Temperature range (short term storage)	-40...+85 °C (-40...+185 °F)	
Humidity	50...95% RH from 25...60 °C (77...140 °F)	

* Performance Data — see page Important-3 of the Industrial Controls catalog.

⚡ Momentary mushroom operators are IP65. Plastic keyed operators are IP66, Type 4/13; not Type 4X.

‡ Limit of four contact blocks max. for these devices.

§ Operating temperatures below 0 °C (32 °F) are based on the absence of freezing moisture and liquids, UL Recognized to 55 °C (131 °F) - Incandescent module max. 40 °C (104 °F).

Product Certifications

Certifications	UR/UL, CSA, CCC, CE
Standards Compliance — CE Marked	NEMA ICS-5; UL 508, EN ISO 13850, EN 60947-1, EN 60947-5-1, EN 60947-5-5
Terminal Identification	EN/IEC 60947-1
Shipping Approvals	ABS
RoHS	✓

Approximate Dimensions

Dimensions in millimeters. Dimensions are not intended to be used for manufacturing purposes. Refer to RAISE software for additional dimensional information.

Non-Illuminated and Illuminated Momentary Flush Push Button Operators

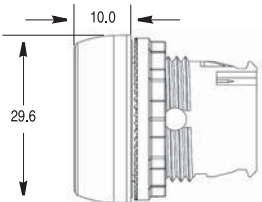

Illuminated Momentary Guarded Push Button Operators

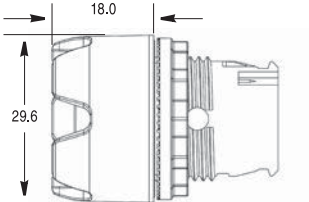

Illuminated and Non-Illuminated Momentary Extended Push Button Operators

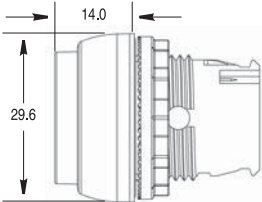

Reset Operators with Reset Rod

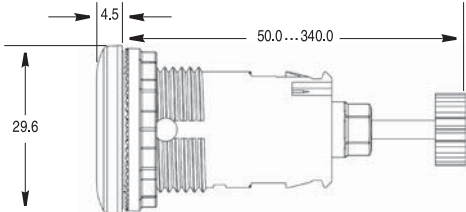

Non-Illuminated Guarded, Illuminated and Non-Illuminated Alternate Action Push Button Operators

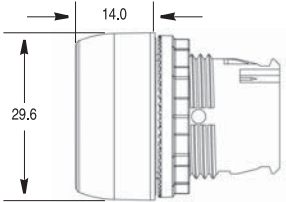

Pilot Light Operators

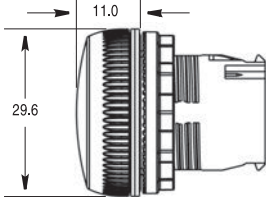

90 mm Half Dome

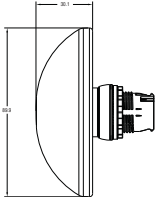

90 mm Mushroom

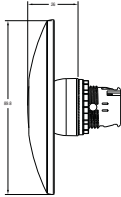

Illuminated and Non-Illuminated Momentary Mushroom Operators 40 mm and 60 mm

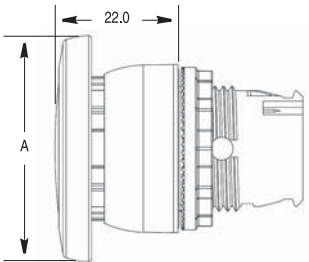

Operator	A
40 mm	39.8
60 mm	59.8

Toggle Switch Operators

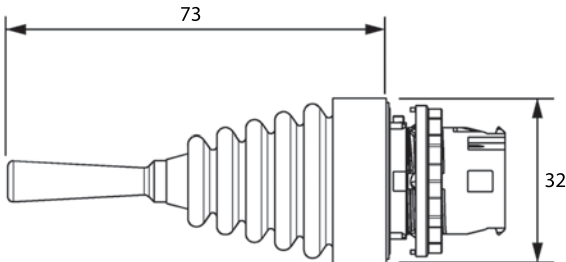

Selector Jog Operators

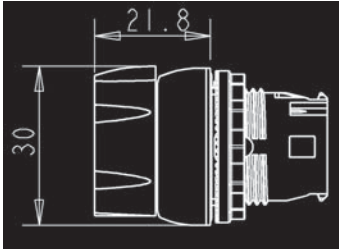

Bulletin 800F

22.5 mm Push Buttons

Approximate Dimensions

Dimensions in millimeters. Dimensions are not intended to be used for manufacturing purposes.

Back-of-Panel Components —
Incandescent Module with Latch

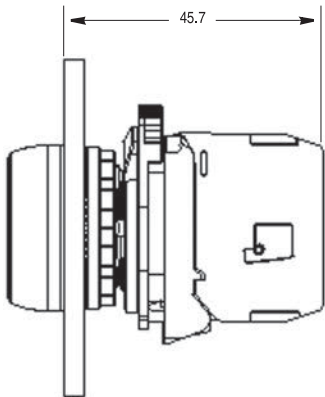

Back-of-Panel Components —
LED Module with Latch

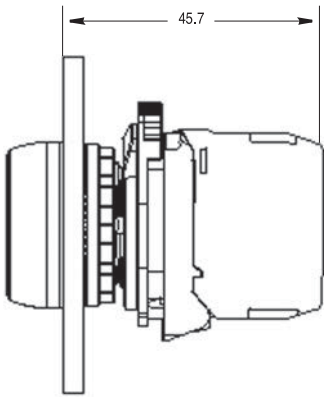

Back-of-Panel Components —
Contact Cartridges with Latch

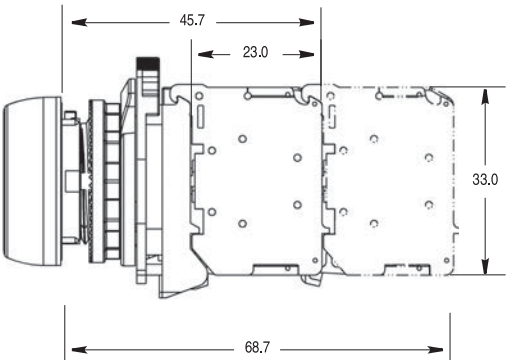

Back-of-Panel Components —
Dual Circuit Contact Block or
Self Monitoring Contact Block
(Max. of 1 Deep)

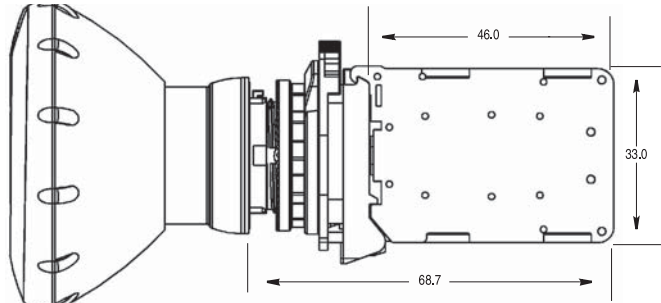

Potentiometer with Resistive Element

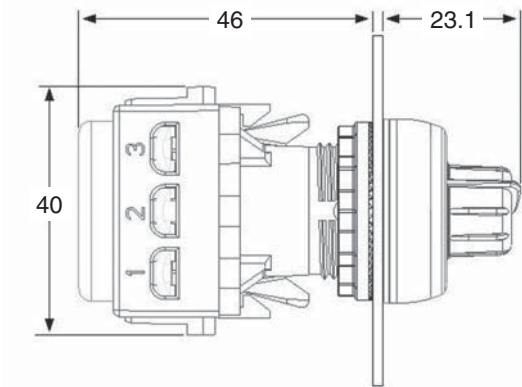

Customer Supplied Resistive Element

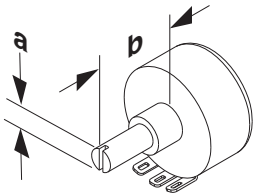

	Max.		Min.
a (Ø Dia.)	6.4 (0.252)	5.9 (0.232)	5.7 (0.224)
b (Length)	24 (0.945)	32 (1.26)	14 (0.551)

Dimensions in millimeters (inches).

30 x 50 mm Snap-In Legend Plate

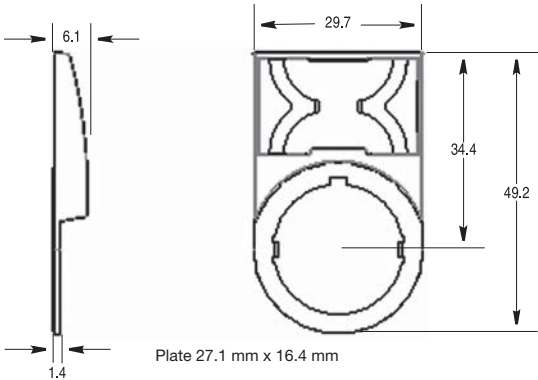

30 x 40 mm Snap-In Legend Plate

