

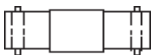
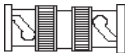

Determining What Type Of Connectors You Need

These connectors are available:

Use this BNC connector:	To:	Cat. No.
cable connector 	attach trunk-cable sections to a tap's BNC connector	1786-BNC
Use this optional BNC connector:	To:	Cat. No.
bullet (jack-to-jack) 	reserve a space in the trunk cable for future installation of a tap or to splice a trunk cable	1786-BNCJ
barrel (plug-to-plug) 	connect two adjacent taps without a trunk-cable section between them	1786-BNCP
isolated-bulkhead (jack-to-jack) 	go through grounded panel walls while maintaining the shield isolation of the trunk-cable.	1786-BNCJI
tap dummy load 	cap off installed taps that have yet to be connected to a node	1786-TCAP
right angle (jack-to-plug) 	provide a 90° bend in your cable (prevent bending your cable excessively). See Chapter 3 for the bend radius specification.	See the Allen-Bradley <i>ControlNet Cable System Component List</i> (publication AG-2.2) for the part number.

In this example, ControlNet cable:

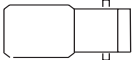
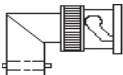
- enters and exits the panel enclosure from the side using isolated-bulkhead connectors
- contains two adjacent taps connected by a barrel connector
- reserves one future tap location with a bullet connector
- makes a sharp bend with a right angle connector

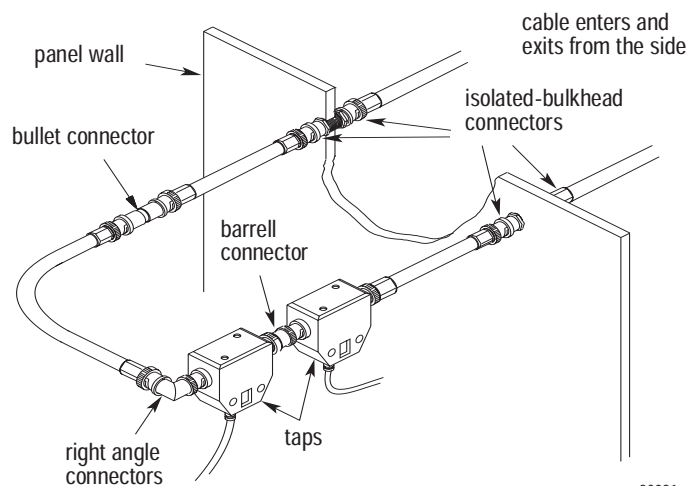

20091-m



ATTENTION: Do not let any metallic surfaces on the BNC connectors, plugs, or optional accessories touch grounded metallic surfaces. This contact could cause noise on the network.